

State of S<sup>c</sup> Carolina Pursuant to a warrant from John Thomas Com<sup>r</sup> of loc<sup>ts</sup> Dated 7<sup>th</sup> March 1788 I have admeasured and laid out unto Thomas Davis a tract of Ninety acres of land in 9<sup>th</sup> District on Indian Creek, waters of Enoree river, bounding N. on John Edwards's land, N.W. on Edwards's line, N.E. & S.E. on lines of Clemm Lewis & 2 runs S.E. on land supposed to be M<sup>r</sup> Turpings, and S.W. on John Lyons line, N.W. on Elenor Lewis line, and hath such shape and Marks as the above Plat Represents,  
Recorded 16<sup>th</sup> April 1788. Survej. 10<sup>th</sup> March 1788.  
W<sup>m</sup> Hunter Det.

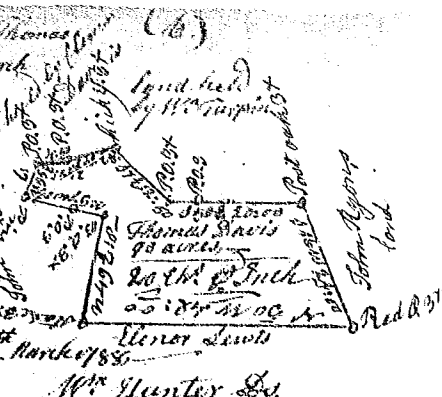

State of S<sup>c</sup> Carolina Pursuant to a warrant from John Thomas Com<sup>r</sup> of loc<sup>ts</sup> Dated 18<sup>th</sup> March 1788, I have admeasured and laid out unto John Gambel a tract of one hundred & sixty nine acres of land in Ninety six District, on a branch of Dunbars Creek called Browns Creek, waters of Enoree River, bounding on all sides as are above mentioned, and hath such shape, marks, buttings and boundings as the above Plat Represents, — Survey. 1<sup>st</sup> April 1788  
Recorded 16<sup>th</sup> April 1788, W<sup>m</sup> Hunter Det.

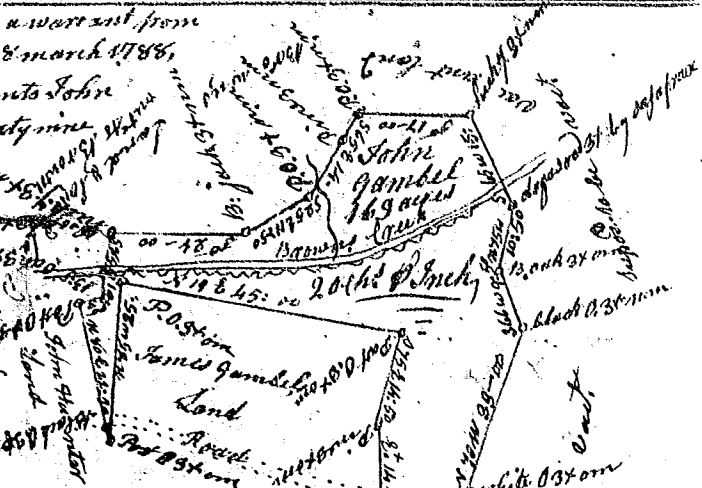

State of S<sup>c</sup> Carolina Pursuant to a warrant from John Thomas Com<sup>r</sup> of loc<sup>ts</sup> Dated 18<sup>th</sup> March 1788, I have admeasured laid out unto John Gambel a tract of 221 acres of land in 96 District, on the waters of Dunbars Creek, on a branch called the S<sup>th</sup> Fork, and hath such shape, marks, buttings & boundings as the above Plat Represents, — Survey. 2<sup>nd</sup> April 1788,  
Recorded 16<sup>th</sup> April 1788, W<sup>m</sup> Hunter Det.

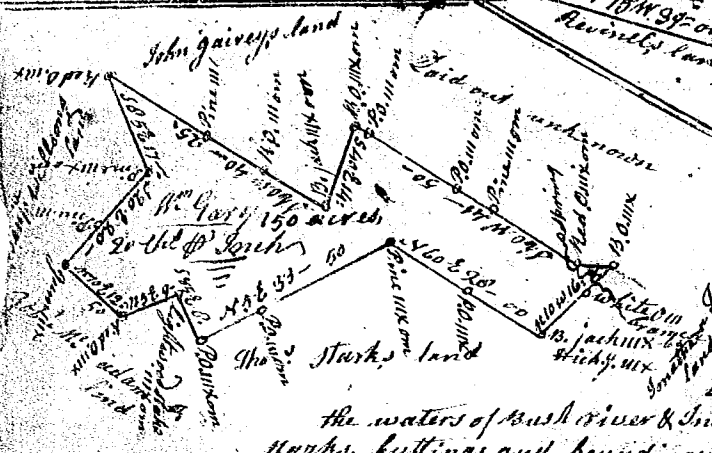
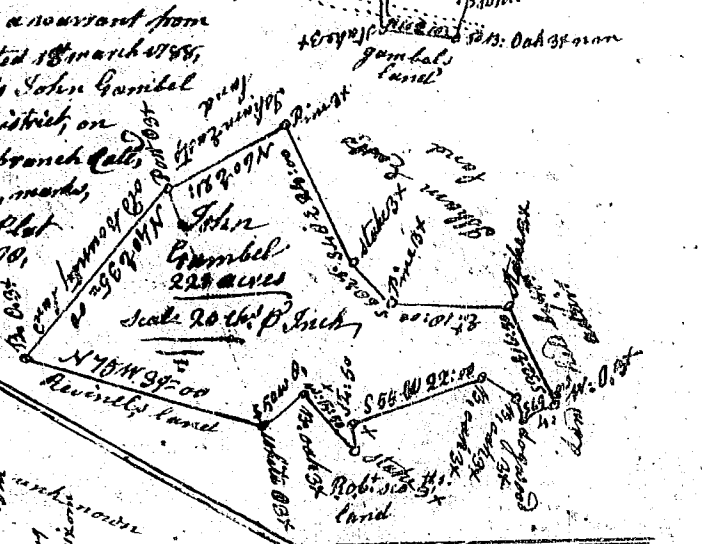

State of S<sup>c</sup> Carolina Pursuant to a warrant from John Thomas Com<sup>r</sup> of loc<sup>ts</sup> Dated 30<sup>th</sup> Oct<sup>r</sup> 1788, I have admeasured & laid out unto William Garry a tract of 150 acres of land in 96 District, Newberry County on the waters of Bush river & Indian Creek, and hath such shape and Marks, buttings and boundings as the above Plat Represents,  
Recorded 11<sup>th</sup> April 1788, Survey. 5<sup>th</sup> Nov<sup>r</sup> 1787, J<sup>n</sup> D<sup>n</sup> Downs Det.

South Carolina Pursuant to a warrant from John Thomas Com<sup>r</sup> of loc<sup>ts</sup> Dated 30<sup>th</sup> Oct<sup>r</sup> 1787 I have admeasured and laid out unto William Garry a tract of Ten Acres of land in said District on the waters of Bush river bounding by a line running S 20° E by land of John Garry, by a line running on the west by Dennis Kellys land, and hath such shape & Marks as the above Plat Represents,  
Recorded 11<sup>th</sup> April 1788, Survey. 5<sup>th</sup> Nov<sup>r</sup> 1787  
John D. Downs Det.

